

Round Back Binders

A round back binder has an architectural curve in the spine which fits the shape of your hand perfectly. The round back also creates a sophisticated look and contributes to the overall strength of the binder.

Styles:

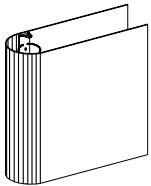

Standard Round Back
Holds 8-1/2" x 11" materials

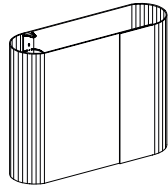

Standard Round Back Portfolio Closure
Holds 8-1/2" x 11" materials

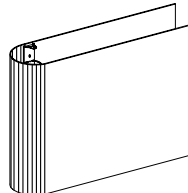

Oblong Round Back
Holds 11" x 8-1/2" materials

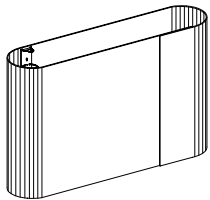

Oblong Round Back Portfolio Closure
Holds 11" x 8-1/2" materials

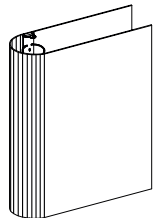

A4 Round Back
Holds 8-1/4" x 11-3/4" materials

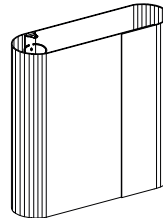

A4 Round Back Portfolio Closure
Holds 8-1/4" x 11-3/4" materials

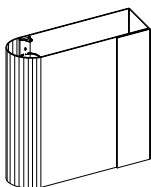

Combination Round And Square Back Portfolio Closure
Holds 8-1/2" x 11" materials

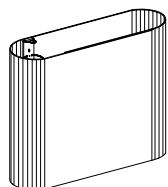

Easel Round back
Holds 11" x 8-1/2" materials
Note: Max. ring size is 1-1/2"

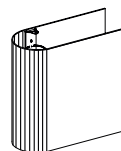

Compact Round Back
Holds 5-1/2" x 8-1/2" materials

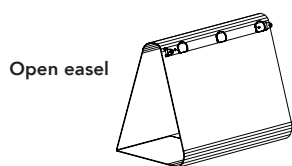

Features

- Binders made from 100% PCW (FSC available)
- Solid hinge for unmatched strength and durability
- Complete design flexibility
- Choice of gloss, matte soft touch or natural matte lamination

Design Options

- Full color graphics—cover and liner
- Choice of round rings or D-rings
- Foil stamping, spot UV, die cutting and debossing
- Alternative cover materials
- Eco-friendly options such as flush-cut and bare board
- Accessories such as corner protectors, pockets and binder clips